

# MALE END VIEW

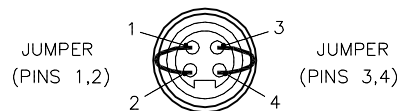

# SPECIFICATIONS

CONTACT CARRIER MATERIAL	TPU
MOLDED BODY MATERIAL/COLOR	TPU/YELLOW
CONTACT MATERIAL/PLATING	BRASS/GOLD
COUPLING NUT MATERIAL/FINISH	STAINLESS STEEL/PASSIVATED
RATED VOLTAGE [V]	300 V
RATED CURRENT [A]	9.0 A
TEMPERATURE RATING	-40°C to +80°C (-40°F to +176°F)
PROTECTION CLASS	MEETS NEMA 1,3,4,6P AND IEC IP67

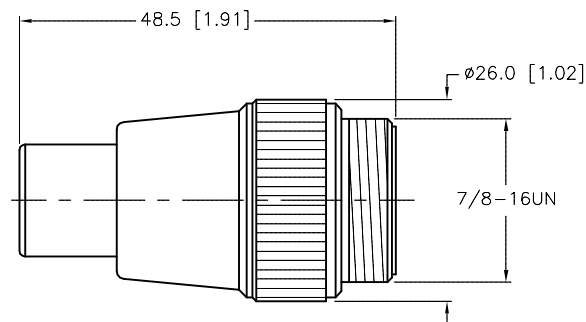

SOURCE DRAWING - FOR REFERENCE ONLY

RELATED DOCUMENTS		3RD ANGLE PROJECTION		<div>THIS DRAWING IS CONFIDENTIAL AND THE PROPERTY OF TURCK INC. USE OF THIS DOCUMENT WITHOUT WRITTEN PERMISSION IS PROHIBITED.</div> <div><b>TURCK INC</b> <i>High Technology Sensors and Automation Controls</i></div> <div>3000 CAMPUS DRIVE MINNEAPOLIS, MN 55441 1-800-544-7769 (763) 553-7300 (763) 553-0708 fax turck.com</div>						
1.										
2.		<div>ALL DIMENSIONS DISPLAYED ON THIS DRAWING ARE FOR REFERENCE ONLY</div> <div>CONTACT TURCK FOR MORE INFORMATION</div>		DRFT RDS		DATE 05/30/13		DESCRIPTION  RSV 40-J12/34		
3.				APVD C.K.		SCALE 1=1.0				
4.				UNIT OF MEASUREMENT  <b>MILLIMETER [ INCH ]</b>  DO NOT SCALE THIS DRAWING				IDENTIFICATION NO.  U2-21676		REV  A
SEE SPECIFICATIONS						FILE: U2-21676		SHEET 1 OF 1		
FINISH										
SEE SPECIFICATIONS										

A	DRAWING RELEASE	RDS	06/11/13	
REV	DESCRIPTION	BY	DATE	ECO NO.